

Air Operated Directional Valve

DG18S4-01C-52**
DG18S2-01A-52**
DG18S4-01A-52**

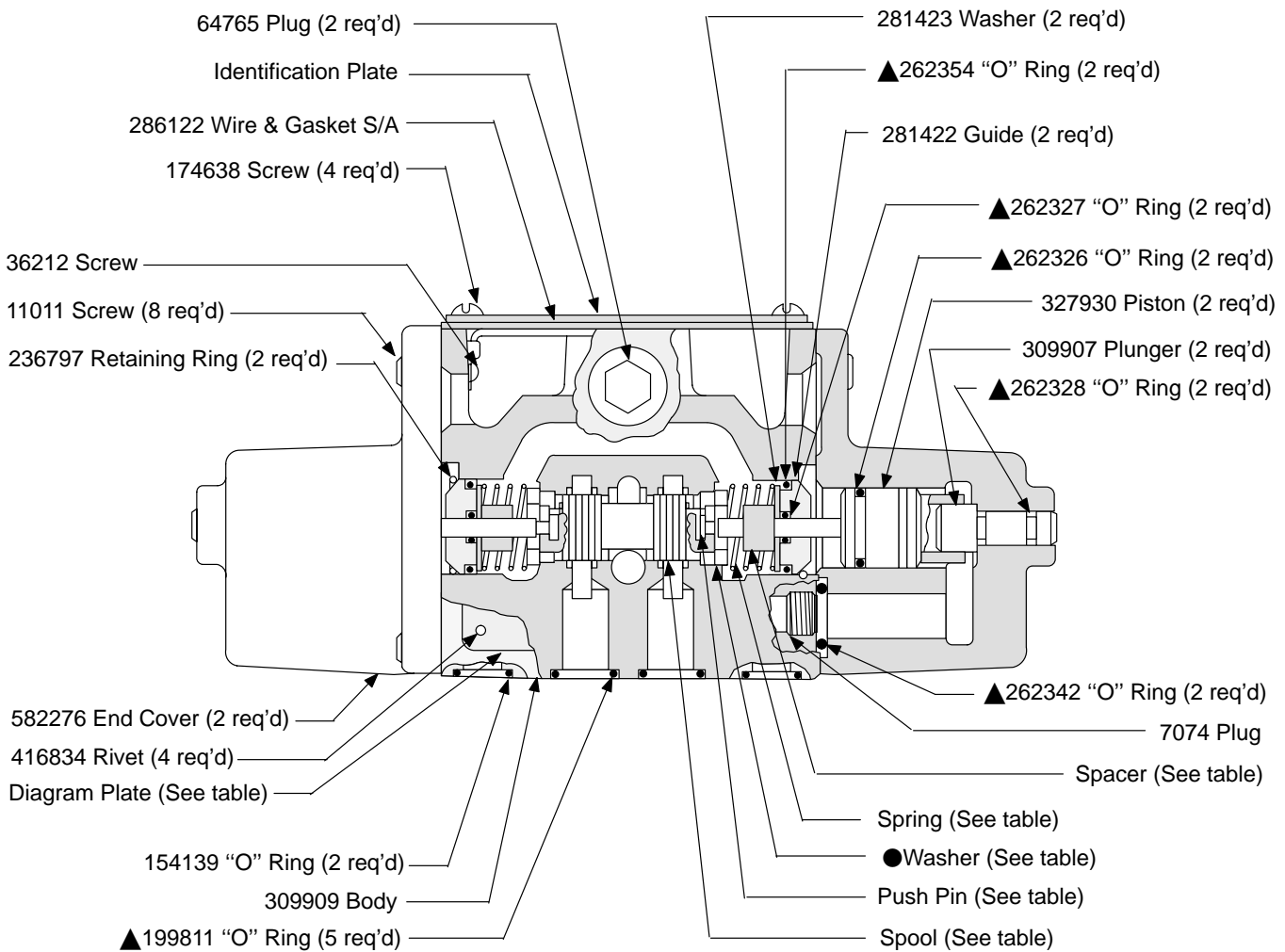

| Model | Spool | Washer (2 req'd) | Spring (2 req'd) | Spacer (2 req'd) | Push Pin (2 req'd) | Diagram Plate |
|-----------------|-----------|---------------------|---------------------|---------------------|-----------------------|------------------|
| DG18S4-010C-52 | 213230 | 211846 | 290072 | 213273 | 213268 | 578447 |
| DG18S4-011C-52 | 276278 | | | | | 578448 |
| DG18S4-012C-52 | 213231 | | | | | 578449 |
| DG18S4-013C-52 | 239903 | | | | | 578450 |
| DG18S4-016C-52 | 213232 | | | | | 578451 |
| DG18S4-017C-52 | 236624 | | | | | 578453 |
| DG18S4-018C-52 | 235637 | 283637 | 217323 | 297745 | 290264 | 578455 |
| DG18S4-0133C-52 | 236615 | 211846 | 290072 | 213273 | 213268 | 578456 |
| DG18S4-0169C-52 | **213232 | | | | | 578452 |
| DG18S4-0179C-52 | ***236624 | | | | | 578454 |

▲ Included in 919681 Seal Kit

● Assemble on spool with sharp edge facing spring.

**Type "69" spool is for use a pilot for spring centered two-stage valves only.

***Type "79" spool is for use as a pilot for pressure centered two stage valves only.

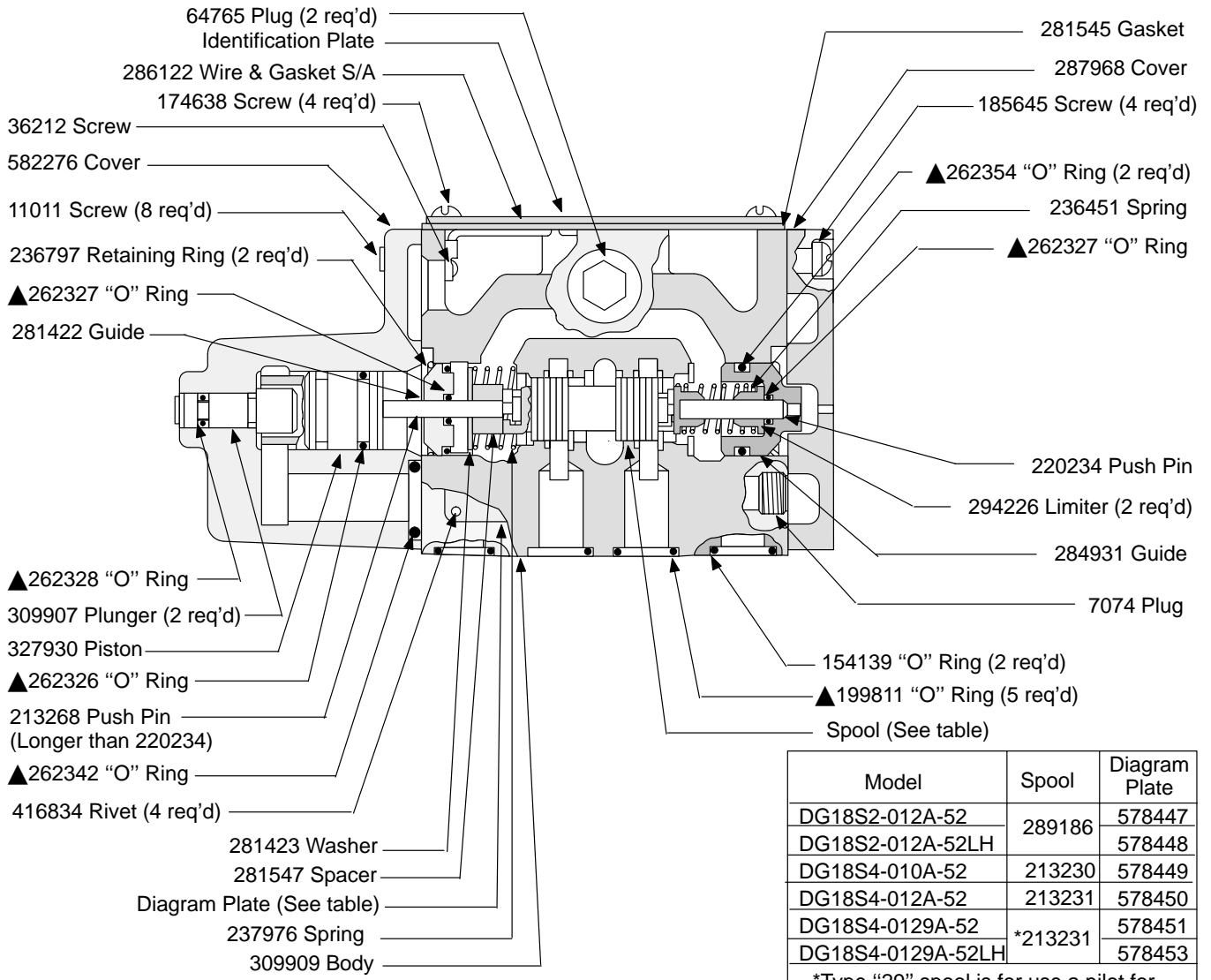

▲ Included in 919681 Seal Kit

RH Assembly shown. The body is reversed for LH Assembly.

| Model | Spool | Diagram Plate |
|-------------------|---------|---------------|
| DG18S2-012A-52 | 289186 | 578447 |
| DG18S2-012A-52LH | | 578448 |
| DG18S4-010A-52 | 213230 | 578449 |
| DG18S4-012A-52 | 213231 | 578450 |
| DG18S4-0129A-52 | *213231 | 578451 |
| DG18S4-0129A-52LH | | 578453 |

*Type "29" spool is for use a pilot for spring offset two-stage valves only.

Use Diagram Plate 578464 for DG18S4LH models with a "0" or "2" spool

Model Code Breakdown

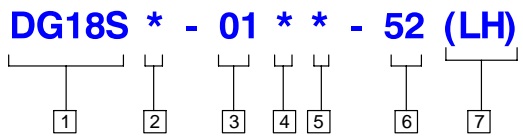

| | | |
|---|---|---|
| <p>1 Model Series</p> <p>DG18S - Directional valve, subplate mounted, air operated with sliding spool</p> | <p>3 Series</p> <hr/> <p>4 Spool Type</p> <hr/> <p>5 Spool/Spring Arrangement</p> <p>A - Spring offset C - Spring centered</p> | <p>6 Design</p> <hr/> <p>7 Left Hand Assembly (Spring offset models only)</p> |
| <p>2 Flow Directions</p> <p>2 - 2 way 4 - 4 way</p> | | |

For satisfactory service life of these components, use full flow filtration to provide fluid which meets ISO cleanliness code 18/15 or cleaner. Selections from Eaton OFP, OFR and OFRS filter series are recommended.