

### Features

#### ● Miniaturization and Low profile

0.50 terminal with 2.0 mm(W) X 2.5 mm(H) pitch is realized miniaturization and low profile.

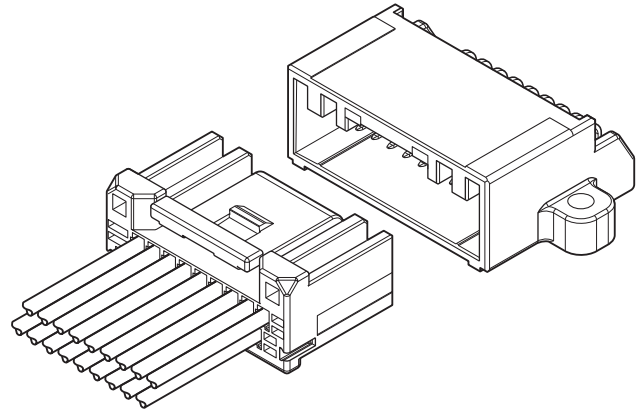

Developed in pursuit of miniaturization and low profile connector for automotive.  
0.50 terminal with 2.0 mm pitch realized miniaturization.

### Specifications

- Current rating: 3 A AC, DC (0.3 mm<sup>2</sup>)
- Voltage rating: 50 V AC, DC
- Temperature range: -40°C to +125°C (gold-plated)  
-40°C to +105°C (tin-plated)  
(including temperature rise in applying electrical current)
- Contact resistance: Initial value/ 15 mΩ max.  
After environmental tests/ 15 mΩ max.
- Insulation resistance: 100 MΩ min.
- Withstanding voltage: 1,000 VAC/minute
- Applicable wire: AESSX 0.3 mm<sup>2</sup>, UL3265 0.3 mm<sup>2</sup>  
(Equivalent to AWG#22, Insulation O.D. φ1.5 mm max.)

\* Compliant with ELV/RoHS2.

\* Contact JST for details.

### Product line-up

Type	No. of circuits	Female side	Male side			Remarks
			Dip type	SMT type	SMT type with flange	
Single row	5	○	○	○		Different key codes (A,B) are available.
	8	○				
	10	○				
	18		○			
Dual row	10	○	○	○	○	
	12	○		○		
	18	○	○			
	20	○		○	○	Different key codes (A,B,C,D,E,F) are available.
	24	○		○	○	Different key codes (A,B,C,D,E,F) are available.

○ : Available

## Female terminal

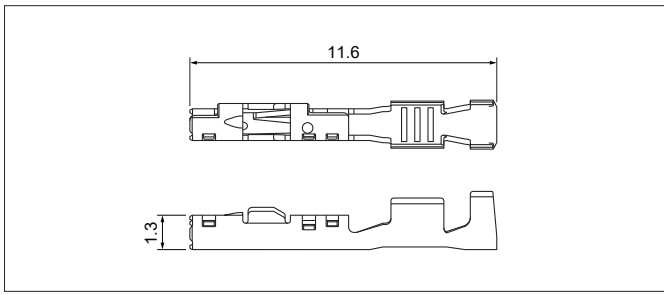

Model No.	Applicable wire range		Q'ty/reel
	Conductor (mm <sup>2</sup> )	Insulation O.D. (mm)	
① SMEC-A021GF-M0.5	0.3	1.5 max.	10,000
② SMEC-A021T-M0.5			

### Material and Finish

- ① Copper alloy, Contact area; gold-plated  
Barrel area; tin-plated
- ② Copper alloy, tin-plated

## Female connector

### Single row

#### ● 5 circuits

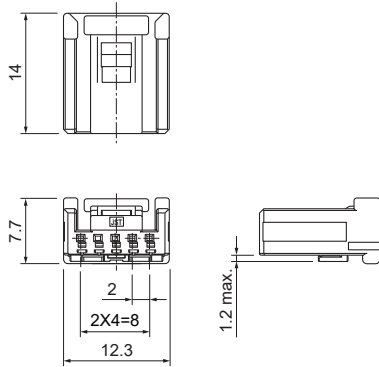

#### ● 8 circuits

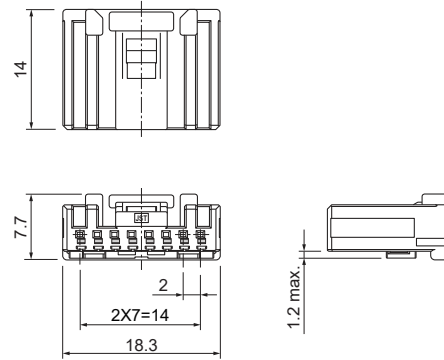

#### ● 10 circuits

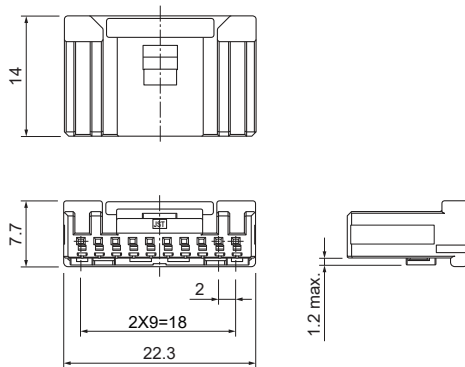

Type	Circuits	Model No.	Q'ty/box
Single row	5	※ 05MEC-B-1A	400
	8	08MEC-B-1A	300
	10	10MEC-B-1A	200

### Material and Finish

Housing: Glass-filled PBT, Black  
Retainer: Glass-filled PBT, Blue

※: Key codes other than above-mentioned housing are also available.  
Contact JST for details.

# MEC CONNECTOR

## Female connector

### Dual row

#### ● 10 circuits

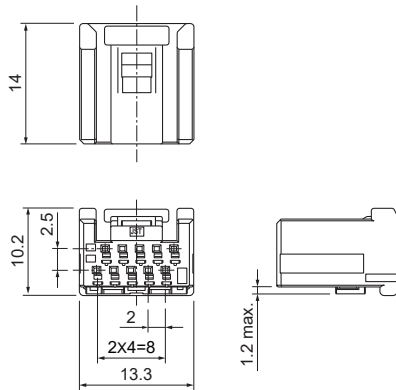

#### ● 12 circuits

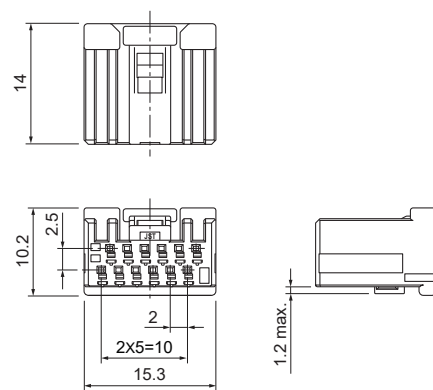

#### ● 18 circuits

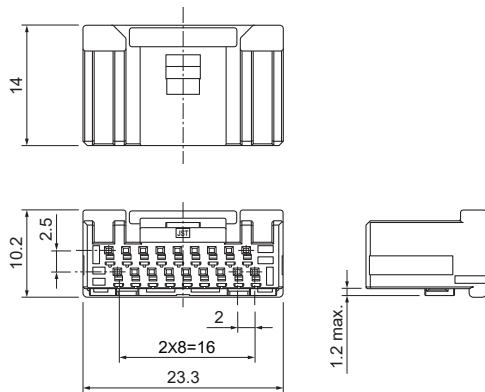

#### ● 20 circuits

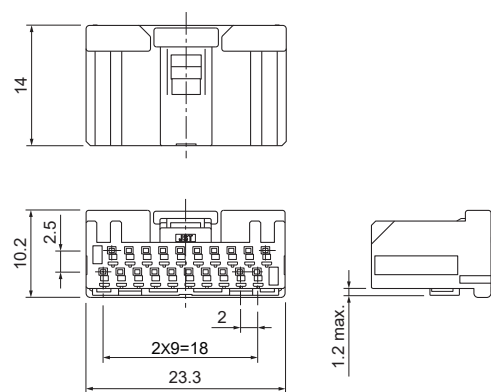

#### ● 24 circuits

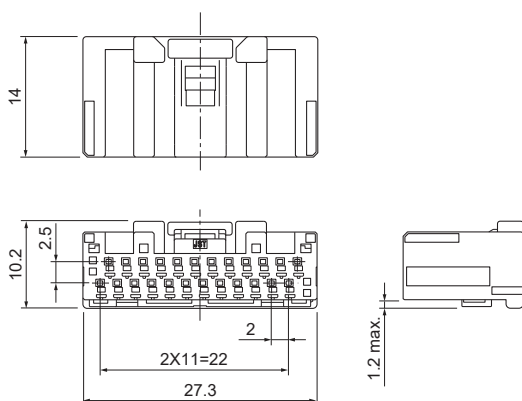

Type	Circuits	Model No.	Q'ty/box
Dual row	10	① 10MEC-B-2A	250
	12	① 12MEC-B-2A	200
	18	① 18MEC-B-2A	150
	20	※ ② 20MEC-B-2A( )	150
	24	※ ① 24MEC-B-2A( )	100

#### Material and Finish

Housing: Glass-filled PBT, Black  
 Retainer: ① Glass-filled PBT, Blue  
 ② Glass-filled PBT, Natural (white)

※: Color/Key codes other than above-mentioned housing are also available.  
 Contact JST for details.

## Male connector

### DIP type

#### Single row

●5 circuits

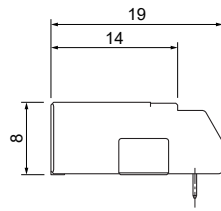
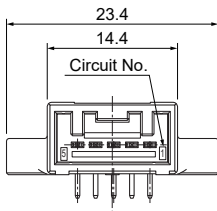
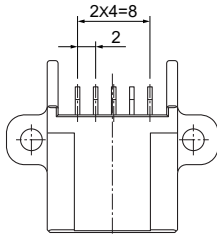

#### Dual row

●10 circuits

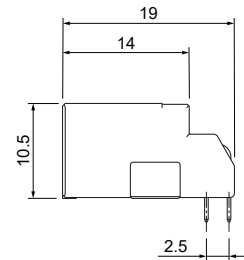
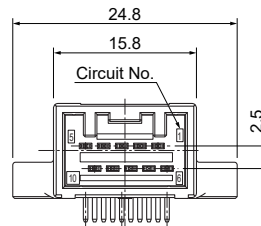
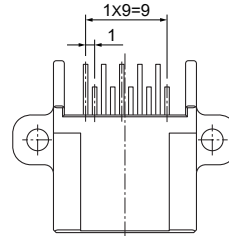

●18 (10+8) circuits

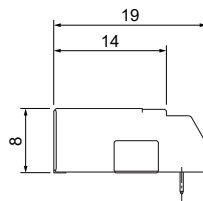
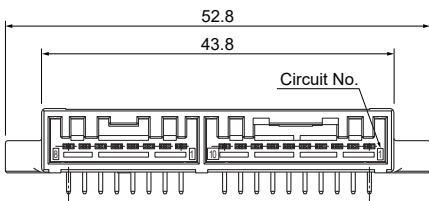
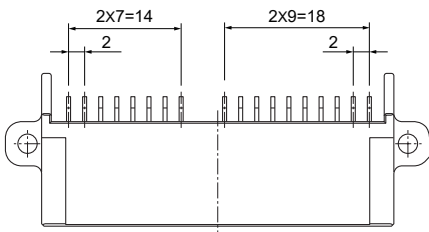

●18 circuits

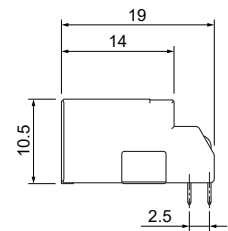
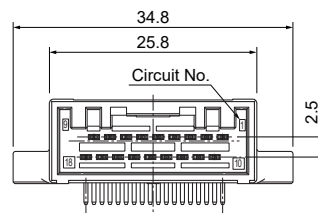
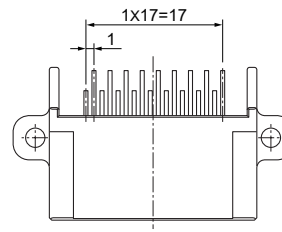

Type	Circuits	Model No.	Q'ty/box
Single row	5	S05B-MECK-1GA-A	700
	18 (10+8)	S18B-MECK-1GA-A	350
Dual row	10	S10B-MECK-2GA-A	504
	18	S18B-MECK-2GA-A	392

#### Material and Finish

Housing: Glass-filled PBT, Black

Terminal: Copper alloy, Contact area; gold-plated

Barrel area; tin-plated (reflow treatment)

Note) In addition to the above, tin-plated type product is also available.  
Contact JST for details.

# MEC CONNECTOR

## Male connector

### SMT type Single row

#### ● 5 circuits

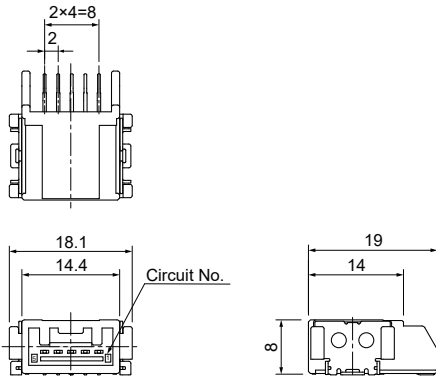

### Dual row

#### ● 10 circuits

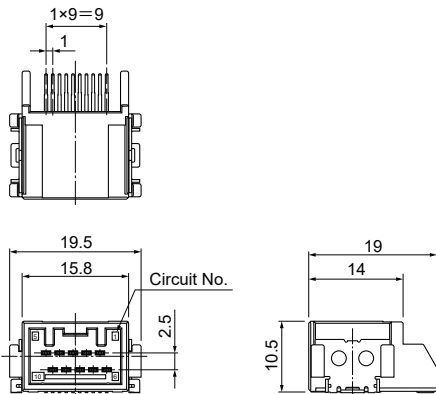

#### ● 12 circuits

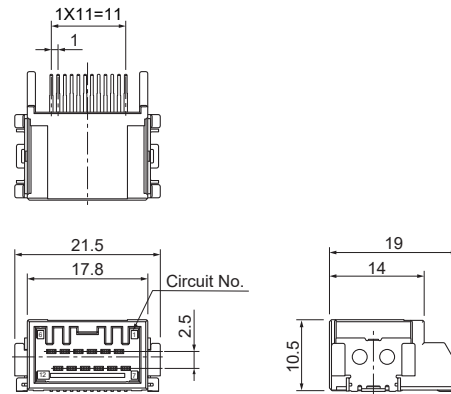

#### ● 20 circuits

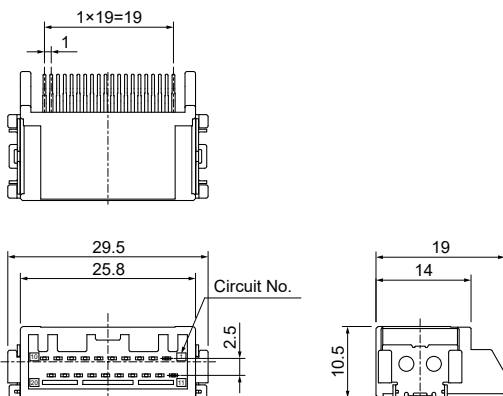

#### ● 24 circuits

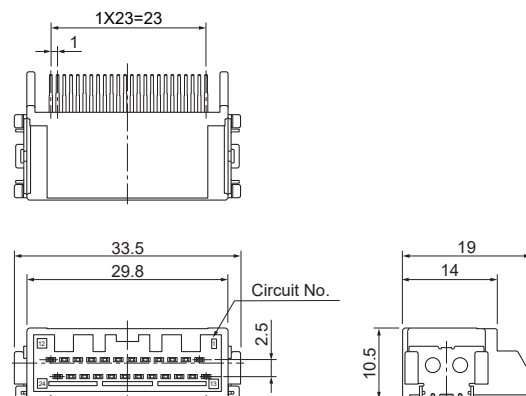

Type	Circuits	Model No.	Q'ty/reel
Single row	5	※2	
Dual row	10	① SM10B-MECK-2GA-A-TB	200
	12	① SM12B-MECK-2GA-A-TB	200
	20	※1② SM20B-MECK-2TA( )-A-TB	200
	24	※1② SM24B-MECK-2TA( )-A-TB	200

#### Material and Finish

Housing: Glass-filled LCP, Black

Terminal: ① Copper alloy, Contact area; gold-plated  
Barrel area; tin-plated (reflow treatment)

② Copper alloy, tin-plated (reflow treatment)

Note) ※1: Key codes other than above-mentioned housing are also available. Contact JST for details.

※2: Contact JST for details of 5 circuits.

In addition to the above, different plating type product is also available. Contact JST for details.

## Male connector

### SMT type

#### Dual row (with flange)

##### ● 10 circuits

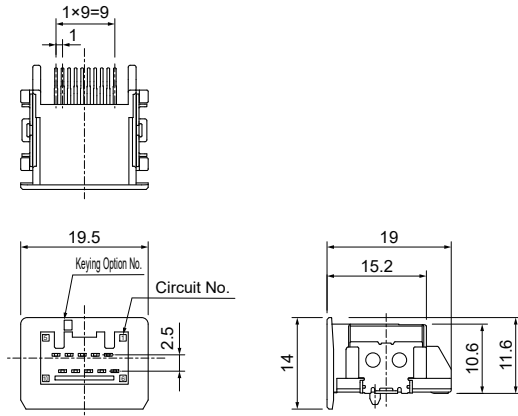

##### ● 20 circuits (SM20B-MECK-2TE( )-A-TB)

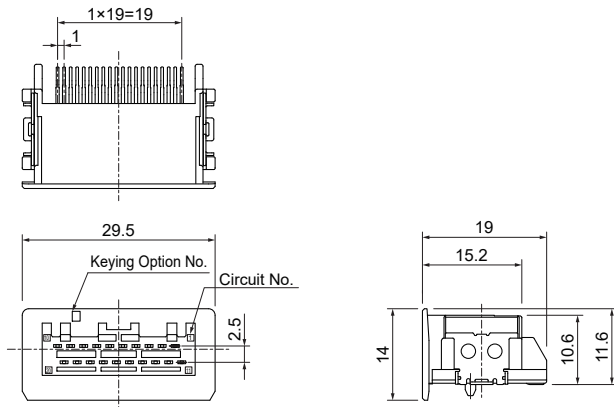

##### ● 20 circuits (SM20B-MECK-2TC( )-A-TB)

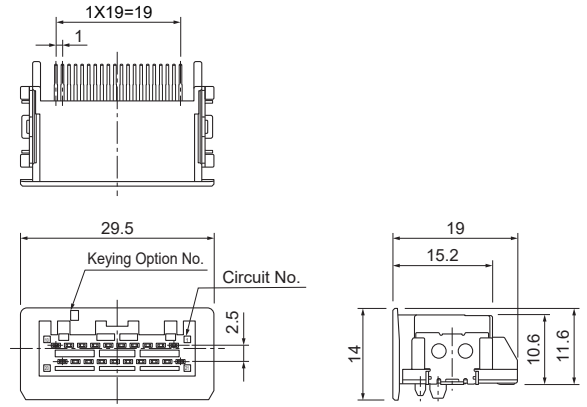

##### ● 24 circuits

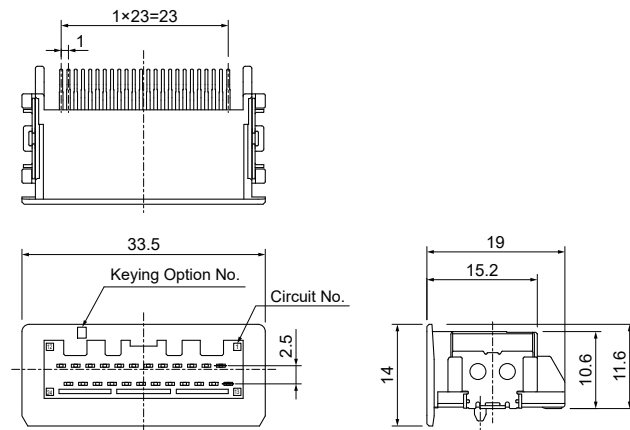

Type	Circuits	Model No.	Q'ty/reel
Dual row	10	※2	
	20	※1 ① SM20B-MECK-2TE( )-A-TB	200
		※1 ② SM20B-MECK-2TC( )-A-TB	200
	24	※2	

#### Material and Finish

Housing: Glass-filled LCP, Black

Terminal: ① Copper alloy, tin-plated (reflow treatment)

② Copper alloy, tin-plated

Note: ※1: Key codes other than above-mentioned housing are also available. Contact JST for details.

※2: Contact JST for details of 10 and 24 circuits.

In addition to the above, gold-plated type product is also available. Contact JST for details.

## Taping specifications

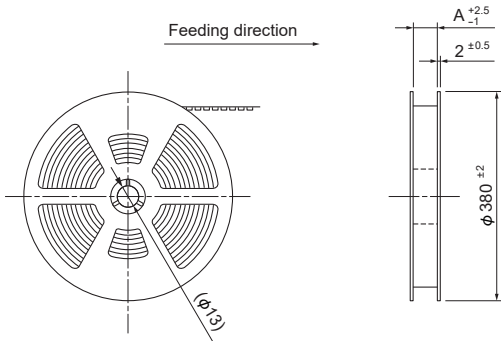

Circuits	A
10	33.5
12	45.5
20	45.5
24	57.5

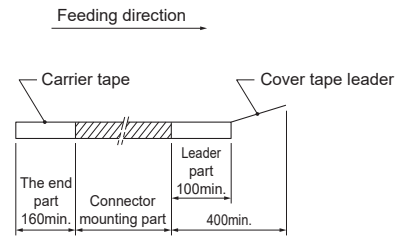

### ●10 circuits

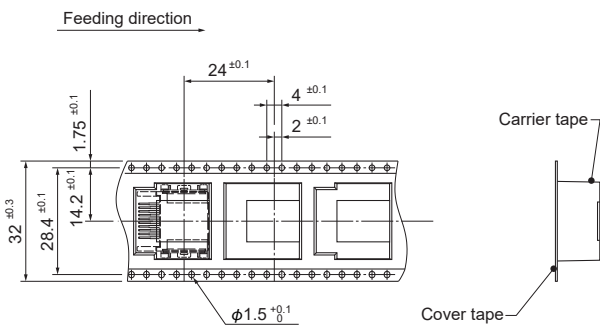

### ●12 circuits

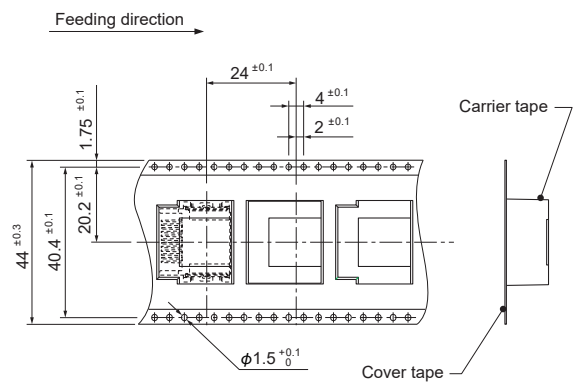

### ●20 circuits

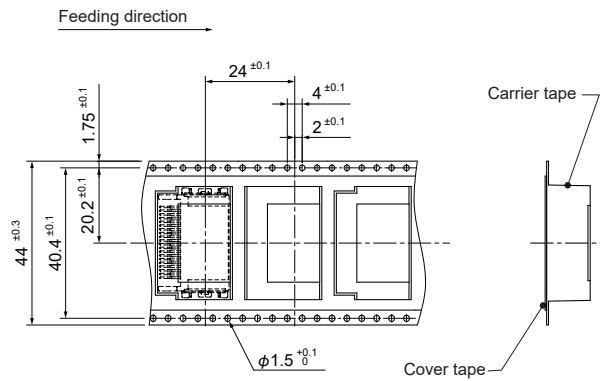

### ●24 circuits

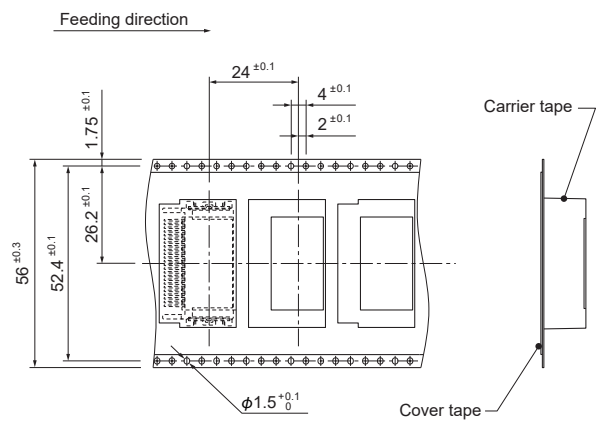

### ●20 circuits (with flange)

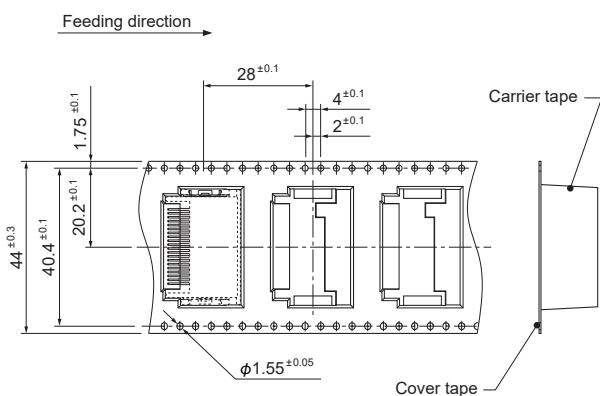

## PC board layout, Assembly layout

### DIP type

#### Single row

● 5 circuits

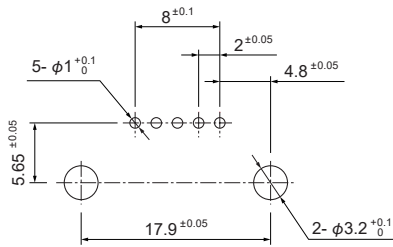

#### Dual row

● 10 circuits

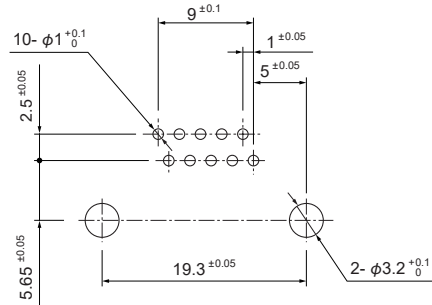

● 18 (10+8) circuits

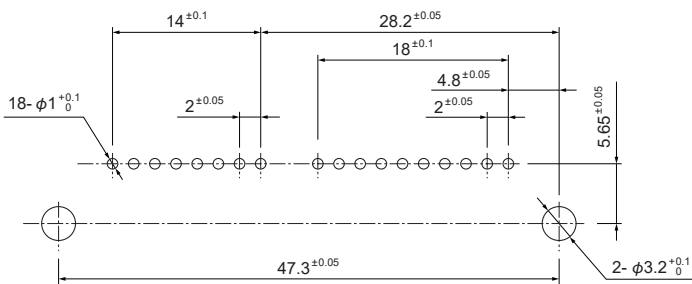

● 18 circuits

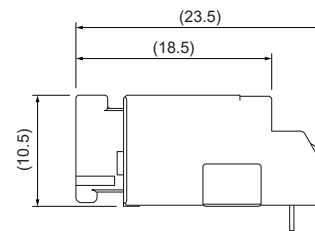
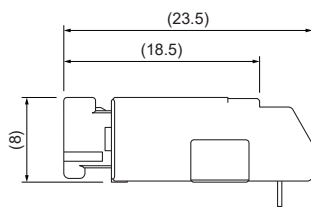
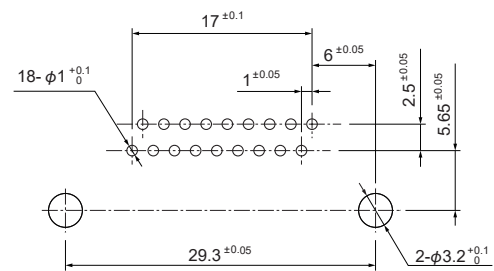

- Note: 1. Tolerances are non-cumulative:  $\pm 0.05$  mm for all centers.  
 2. Hole dimensions differ according to the type of PC board and piercing method.  
 The dimensions above should serve as guideline. Contact JST for details.



## PC board layout, Assembly layout

### SMT type Single row

#### ●5 circuits

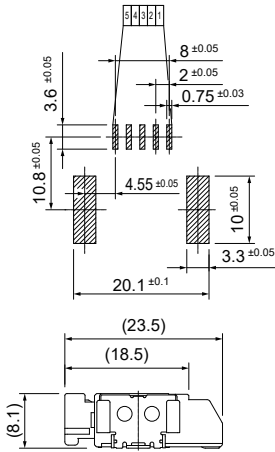

### Dual row

#### ●10 circuits

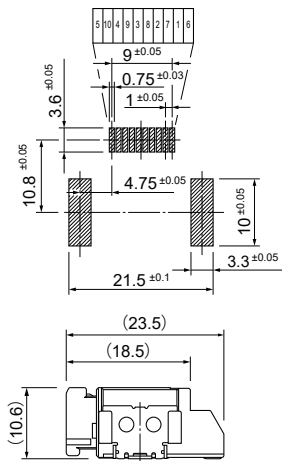

#### ●12 circuits

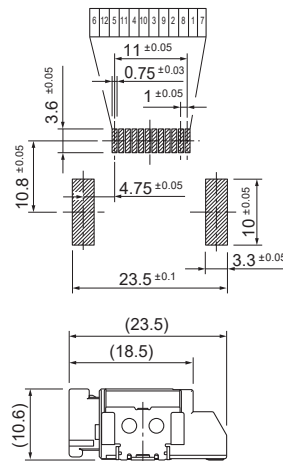

#### ●20 circuits

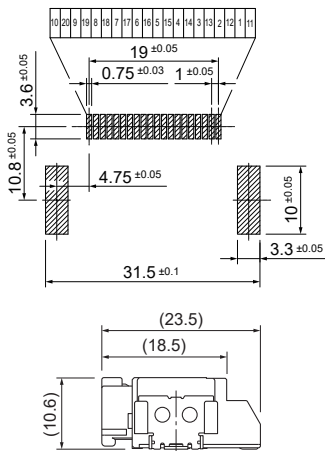

#### ●24 circuits

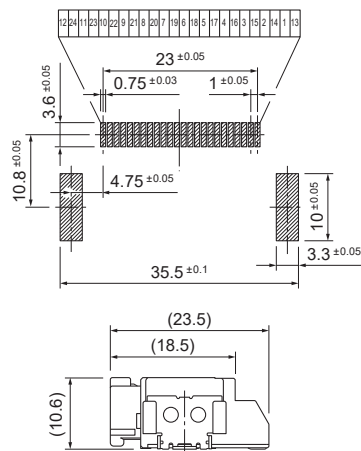

Note: Tolerances are non-cumulative:  $\pm 0.05$  mm for all centers.  
The dimensions above should serve as guideline. Contact JST for details.

## PC board layout, Assembly layout

### SMT type

#### Dual row (with flange)

##### ● 10 circuits

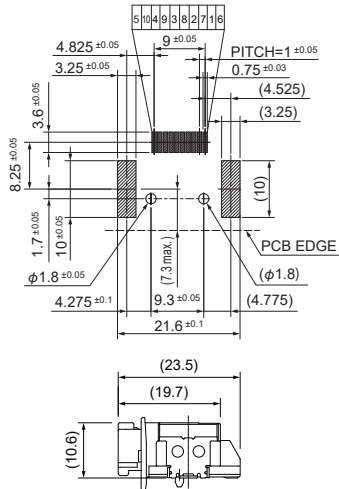

##### ● 20 circuits (SM20B-MECK-2TE (-)A-TB)

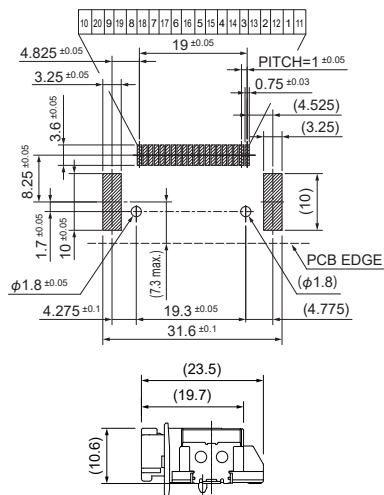

##### ● 20 circuits (SM20B-MECK-2TC (-)A-TB)

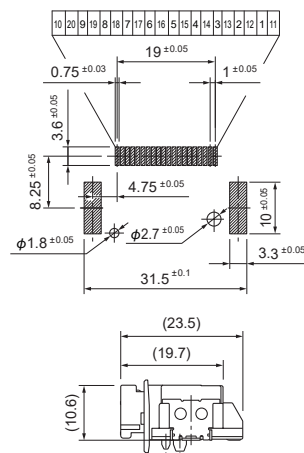

##### ● 24 circuits

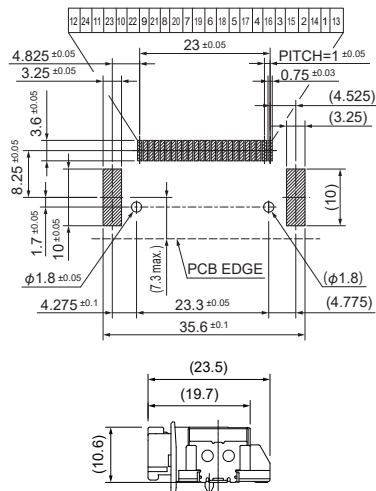

Note: Tolerances are non-cumulative:  $\pm 0.05$  mm for all centers.  
The dimensions above should serve as guideline. Contact JST for details.

## Crimping machine, Applicator

Strip terminal	Crimping machine	Crimp applicator MKS-L	
		Dies	Crimp applicator with dies
SMEC-A021GF-M0.5	AP-K2N	MK/SMEC-A021-05	APLMK SMEC-A021-05
SMEC-A021T-M0.5			

Note: When crimping operation is conducted using an applicator and die set other than the above, JST cannot guarantee the performance of the terminal.