

## Quick Start Guide - SIREC D300 and D400 Display Recorders

### 1. Connections

#### D300 rear panel

1) 24VDC Inst. power  
2) 24V TXP Supply  
3) Common Relay Output  
4) RS485 connection  
5) USB Host  
6) Ethernet connection  
7) AC supply 100-250VAC  
8) CJC Connector

#### D400 rear panel

**Analogue Input board (4, 6 or 8 channel).  
D300 = Slots A & B, D400 = Slots A to F**

**Analogue Output (2 or 4 channel). D300 = Slot B only, D400 = Slots E&F**

**Pulse Input (4 channel). D300 = Slots A & B, D400 = Slots A to F**

**Relay Alarm (4 or 8 channel). D300 = Slot G, D400 = Slots G to I**

**Digital Input/Output (8 or 16 channel).  
D300 = Slot G, D400 = Slots G to I**

**Key: NO = Normally Open, C = Common, NC = Normally Closed,**  
(2) 24V Transmitter Power Supply connections are made via 2-way for D300, 2x10-way connectors for D400.

### 2. Setup Menu

Select the Menu button from the Process Screen

Configure Setup Edit

#### Options

Select Options in Credits menu, tick firmware options to enable. Go to Finish and Commit

#### Inputs

All Analogue Inputs default to 12V

Select Input channel

- Setup input Type. V, A, Ohms, RT, TC
- Select Sample Rate
- Select Range / RT / TC Type

Use Back button to return to Setup Menu

#### Pens

By default Pen 1 displays Analogue Input 1, Pen 2 displays Analogue 2 etc.

Select Pen

- Setup Scale
- Set Alarms, if required
- Setup Logging (required to Log and Save data in memory)

Use Back button to return to Setup Menu

#### Localization

Settings for Language and Time Zones, etc.

Back

#### Settings (Main Menu > Configure)

Set Date and Time

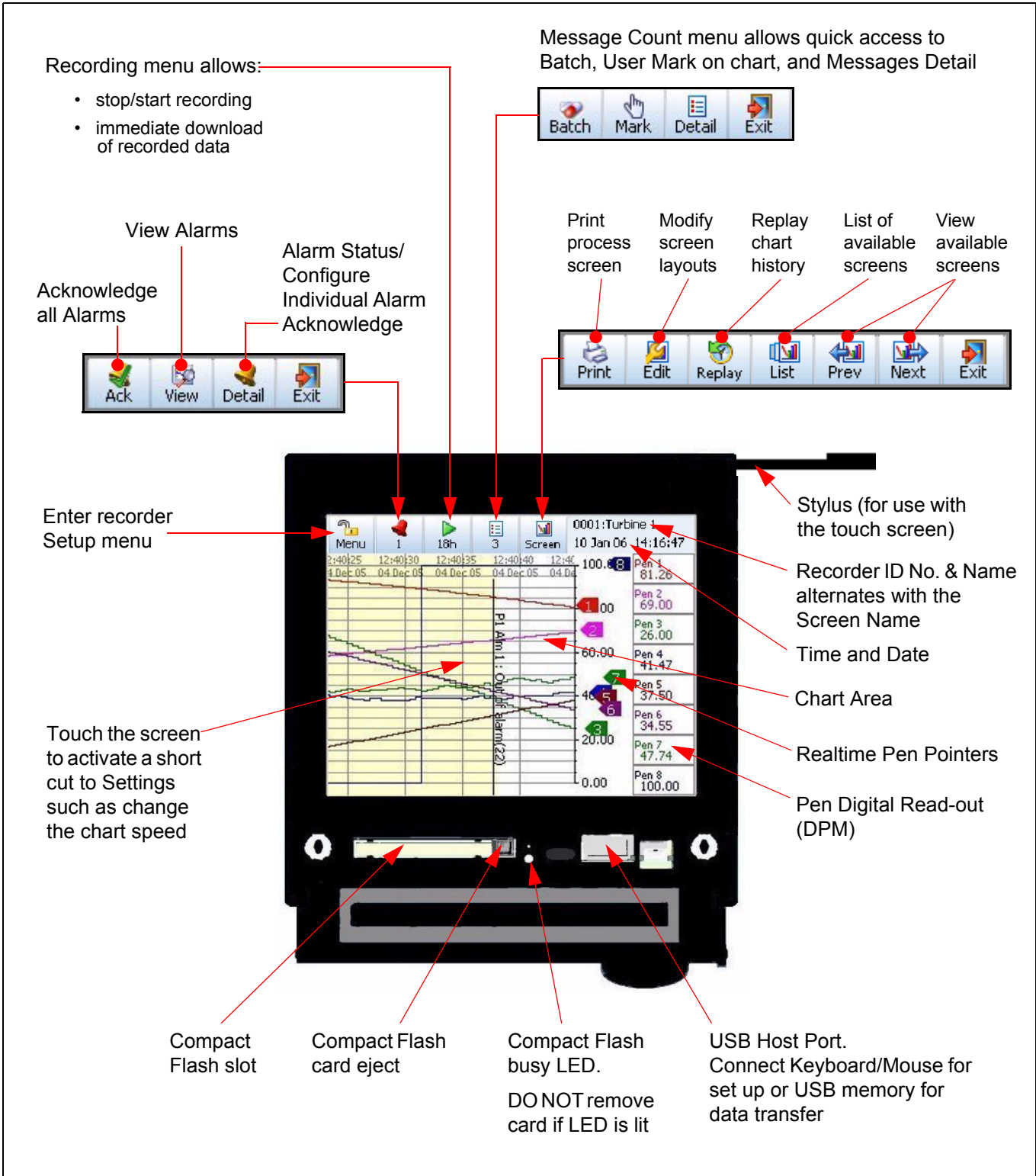

**NOTICE**

For detailed information on all recorder settings and configuration parameters please refer to the SIREC D200, D300, D400 Manual.