

AUTOCAD CREATED DRAWING.DON'T CHANGE BY HAND.

REV.	ECN. NO.	APPD.
A	BC06728476	JOHN CHOW

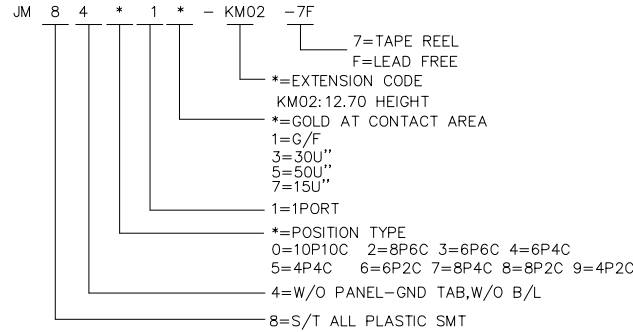
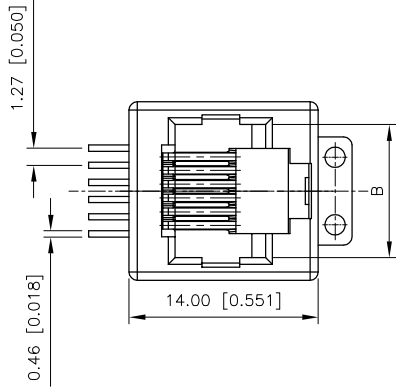

SPECIFICATIONS:

- ELECTRICAL:
 - CURRENT RATING: 1.5 AMPERES MAXIMUM
 - VOLTAGE RATING: 150 VAC
 - INSULATION RATING: 500 MEGOHMS MINIMUM
 - DIELECTRIC WITHSTANDING VOLTAGE: 1000 VDC CONTACT TO CONTACT
- MECHANICAL:
 - MATING FORCE: 4POUNDS MAXIMUM WITH LATCH DEPRESSED AT AN ADVANTAGEOUS ANGLE
UNMATING FORCE: 4 POUNDS MAXIMUM WITH LATCH DEPRESSED AT AN ADVANTAGEOUS ANGLE
PLUG RETENTION FORCE: 10 POUNDS MINIMUM
 - DURABILITY (MATING/UNMATING): 1000 CYCLES
 - OPERATING TEMPERATURE RANGE: 0° C TO +70° C.

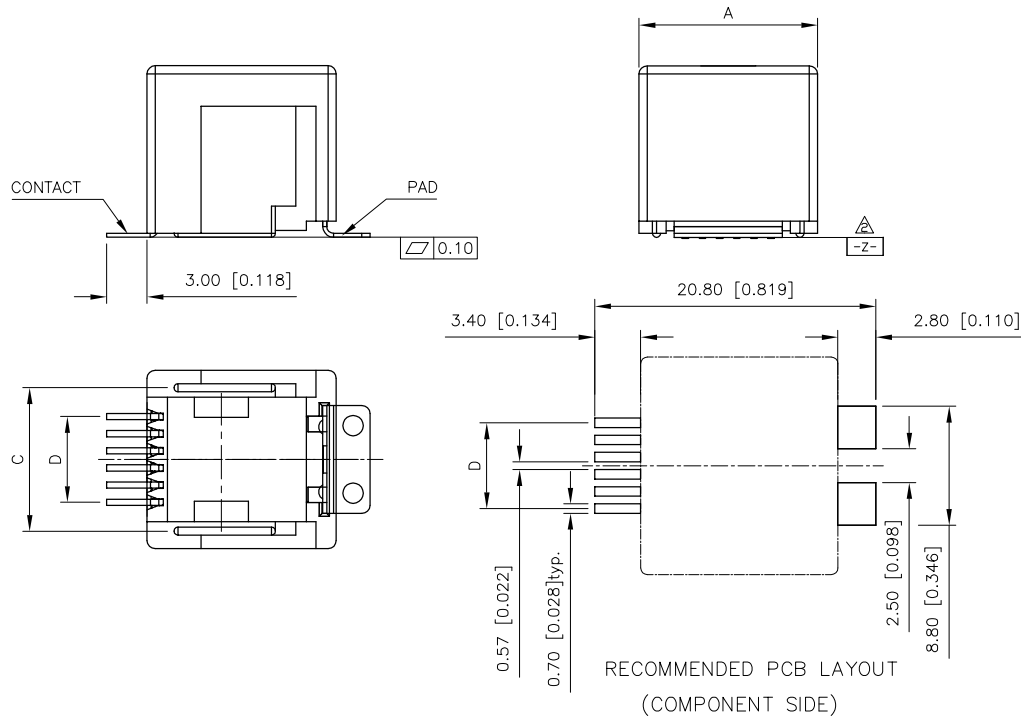

P/N	DIMENSIONS			
	A	B	C	D
JM8451*-KM02-7F	13.21	7.80	10.61	3.81
JM8441*-KM02-7F	13.21	9.85	10.61	3.81
JM8431*-KM02-7F	13.21	9.85	10.61	6.35

NOTES: UNLESS OTHERWISE SPECIFIED.

- CONNECTOR TO COMPLY WITH CFR TELECOMMUNICATION STANDARD PART 68 SUBPART F.
- TOP PC BOARD SURFACE PLANE ().
- RECOMMENDED ASSEMBLY PROCESS : IR-REFLOW PEAK TEMPERATURE :250°C TIME 5S MAX

ITEM	DESCRIPTION	Q'TY	MATERIAL	TREATMENT	REMARK
3	PAD	1	STEEL	50u"MIN TIN ALLOY PLATED OVERALL, 50u"MIN NICKEL UNDER PLATING	
2	CONTACT	N	PHOSPHOR BRONZE	50u"MIN NICKEL PLATED OVERALL, 50u"MIN LEAD FREE TIN PLATED AT SOLDER TAIL 50u"MIN GOLD PLATED AT CONTACT AREA	
1	HOUSING	1	THERMOPLASTIC UL 94V-0	MOLDED BLACK	

UNITS	MM [inch]	NAME(INTENDED USE)	FOXCONN HON HAI PRECISION IND. CO.,LTD. TAIPEI, TAIWAN, R.O.C.
X.±	X° ± 2°	CUSTOMER	
.X± 0.35[.014]	.X° ± 1°	PART NO.(INTENDED USE)	TITLE: MODUJACK VERTICAL SMT (12.70mm Height)
.XX± 0.25[.010]	.XX° ±	JM84*1*-KM02-7F	
.XXX±	.XXX° ±	APPD: JOHN CHOW 05/10'06	DWG NO: 305-0000-1805
THESE DRAWINGS AND SPECIFICATIONS ARE THE PROPERTY OF HON HAI PRECISION IND. CO., LTD. AND SHALL NOT BE REPRODUCED COPIED OR USED IN ANY MANNER WITHOUT THE PRIOR WRITTEN CONSENT OF HON HAI PRECISION IND. CO., LTD.	Q'TY	CHKD: Q.WAN 05/10'06	SCALE SHEET REV. 1:1 1/1 A
		DR: D.K.LIU 05/10'06	