

IDEAS GENERATED DRAWING. DON'T CHANGE BY HAND.

REV.	ECN. NO.	APPD.
A	BC05747909	JOHN CHOW
B	BC06735541	JOHN CHOW
C	BC-08-7043622	L.C.WU

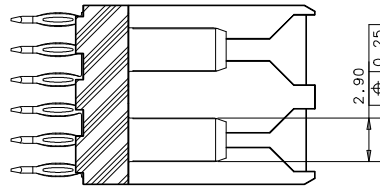
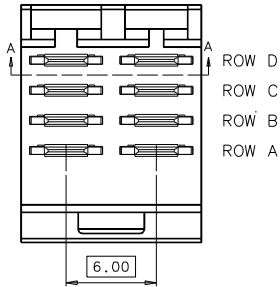

SECTION A-A

NOTES: UNLESS OTHERWISE SPECIFIED.

△ PRESS FIT HOLES:

- 1) HOLE DIAMETER AFTER PLATING: 0.65*0.80mm.
- 2) DRILLED HOLE: 0.81*0.86mm.
- 3) COPPER PLATING: 0.025mm MIN.
- 4) TIN-LEAD OR LEAD FREE PLATING: 0.005*0.015mm.

2. ELECTRICAL CHARACTERISTICS:

- 1) CURRENT RATING: 2.75A MAX. PER CONTACT WITH ALL CONTACTS ENERGIZED.
- 2) DIELECTRIC WITHSTANDING VOLTAGE: 1000 V A.C.

3. MECHANICAL CHARACTERISTICS:

- 1) THE PRESS FIT INSERTION FORCE TO BE 100 N MAX. PER PIN AND THE WITHDRAWAL FORCE TO BE 20 N MIN. PER PIN.
- 2) THE MATING FORCE OF HEADER & REC. TO BE 1.5 N MAX. PER PIN AND THE UNMATING FORCE TO BE 0.3 N MIN. PER PIN.
4. DESIGNED TO CONFORM WITH IEC 61076-4-104.

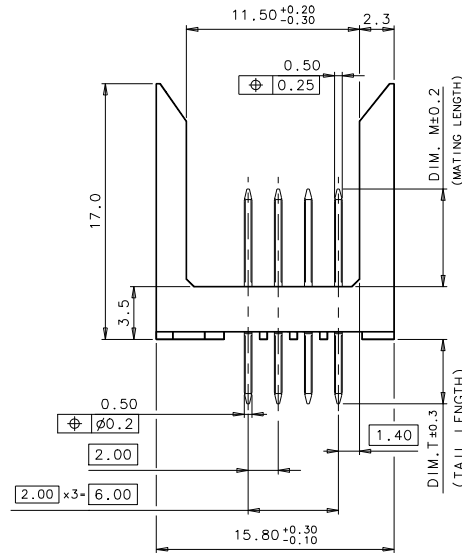
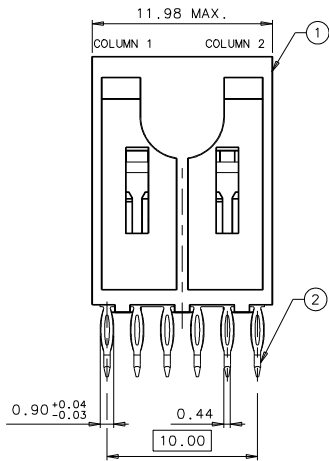

PART LIST

POS. NO.(N)	1 F 1 3 0 0 8 * - P * * 1 S * * *	LEAD FREE CODE
008: 8 POS.		N: NONE
		F: LEAD FREE PLATING
		PACKAGE TYPE
		A: TUBE
		EXTENSION CODE
		N: NORMAL PLATING
		S: SELECTIVE PLATING
		BODY STYLE
		1S: SELECTIVE PIN
		SELECTIVE PIN PATTERN
		(SEE THE TABLE)
		TAIL STYLE
		P: PRESS FIT TYPE

PLATING SPEC.
 1: GOLD FLASH
 3: 0.76um(30u*)MIN. GOLD PLATING
 5: 1.27um(50u*)MIN. GOLD PLATING
 6: 0.25um(10u*)MIN. GOLD PLATING
 A: 0.76um(30u*)MIN. FPT PLATING,
 0.25um(10u*)MIN. GOLD INCLUDED
 C: 1.27um(50u*)MIN. FPT PLATING,
 0.51um(20u*)MIN. GOLD INCLUDED
 D: 1.27um(50u*)MIN. FPT PLATING,
 0.25um(10u*)MIN. GOLD INCLUDED
 K: 0.51um(20u*)MIN. FPT PLATING,
 0.13um(5u*)MIN. GOLD INCLUDED

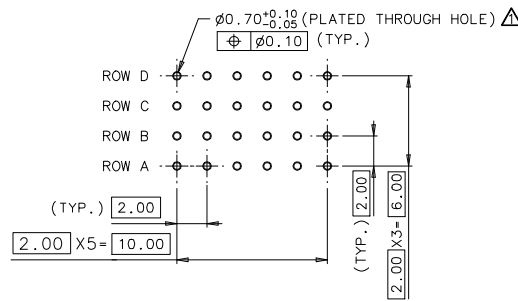
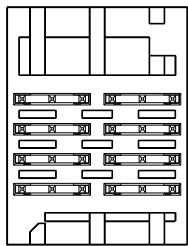

RECOMMENDED PCB LAYOUT
(COMPONENT SIDE)

2	CONTACT	PHOSPHOR BRONZE	1) 2.54um(100u*)MIN. NICKEL UNDERPLATING. 2) 0.76um(30u*)MIN. TIN LEAD OR LEAD FREE PLATING ON PRESS FIT AREA. 3) PLATING SPEC. OF MATING AREA, DETAIL REFER TO PART LIST.
1	HOUSING	LCP	IVORY WHITE, UL 94V-0
ITEM	DESCRIPTION	MATERIAL	TREATMENT
X.±	X.± 5*	UNITS mm	FOXCONN HON HAI PRECISION IND. CO., LTD. TAIPEI, TAIWAN, R.O.C. TITLE: CUSTOMER DWG. FOR F/B POWER HEADER 4ROW PRESS FIT TYPE DWG NO.: 343-0000-1131 SCALE SHEET REV. 4:1 1/2 C
.X± 0.20	.XX±	MAT'L	
.XX± 0.10	.XXX±	N/A	
.XXX±	.XXX±	FINISH	
		N/A	
THESE DRAWINGS AND SPECIFICATIONS ARE THE PROPERTY OF HON HAI PRECISION IND. CO., LTD. AND SHALL NOT BE REPRODUCED, COPIED OR USED IN ANY MANNER WITHOUT THE PRIOR WRITTEN CONSENT OF HON HAI PRECISION IND. CO., LTD.		Q'TY	APPD: L.C.WU 05/10'08 CHKD: Camvard 05/08'08 DR: THOMAS ZHAO 05/08'08

PRODUCT NUMBER	CONF I G U R A T I O N		
	ROW NO.	C O L U M N 1	C O L U M N 2
1F13008*-P031S*--**	ROW D	13	13
	ROW C	14	14
	ROW B	15	15
	ROW A	14	14

PRODUCT NUMBER	CONF I G U R A T I O N		
	ROW NO.	C O L U M N 1	C O L U M N 2
1F13008*-P071S*--**	ROW D	14	15
	ROW C	14	15
	ROW B	14	15
	ROW A	14	15

PRODUCT NUMBER	CONF I G U R A T I O N		
	ROW NO.	C O L U M N 1	C O L U M N 2
1F13008*-P041S*--**	ROW D	13	13
	ROW C	14	14
	ROW B	15	15
	ROW A	15	15

PRODUCT NUMBER	CONF I G U R A T I O N		
	ROW NO.	C O L U M N 1	C O L U M N 2
1F13008*-P081S*--**	ROW D	13	13
	ROW C	13	13
	ROW B	14	14
	ROW A	13	13

PRODUCT NUMBER	CONF I G U R A T I O N		
	ROW NO.	C O L U M N 1	C O L U M N 2
1F13008*-P051S*--**	ROW D	13	13
	ROW C	13	13
	ROW B	14	14
	ROW A	15	15

PRODUCT NUMBER	CONF I G U R A T I O N		
	ROW NO.	C O L U M N 1	C O L U M N 2
1F13008*-P091S*--**	ROW D	13	13
	ROW C	13	13
	ROW B	15	15
	ROW A	13	13

PRODUCT NUMBER	CONF I G U R A T I O N		
	ROW NO.	C O L U M N 1	C O L U M N 2
1F13008*-P061S*--**	ROW D	13	14
	ROW C	14	14
	ROW B	13	15
	ROW A	13	15

PRODUCT NUMBER	CONF I G U R A T I O N		
	ROW NO.	C O L U M N 1	C O L U M N 2
1F13008*-P0A1S*--**	ROW D	13	13
	ROW C	13	13
	ROW B	15	15
	ROW A	13	13

CODE	D I M E N S I O N S	
	D I M . T	D I M . M
11	4.30	5.00
12	4.30	5.75
13	4.30	6.50
14	4.30	7.25
15	4.30	8.00

X.±	X°.±	UNITS mm	NAME (INTENDED USE) FUTURE BUS HEADER CONNECTOR	FOXCONN HON HAI PRECISION IND. CO., LTD. TAIPEI, TAIWAN, R.O.C.
.XX±	.XX°.±	MAT'L N/A	PART NO. (INTENDED USE) 1F13008*-P**1S*--**	
.XXX±	.XXX°.±	FINISH N/A	APPD: L.C.WU 05/10'08	TITLE: CUSTOMER DRAWING F/B POWER 4 ROW PRESS FIT TYPE
THESE DRAWINGS AND SPECIFICATIONS ARE THE PROPERTY OF HON HAI PRECISION IND. CO., LTD. AND SHALL NOT BE REPRODUCED, COPIED OR USED IN ANY MANNER WITHOUT THE PRIOR WRITTEN CONSENT OF HON HAI PRECISION IND. CO., LTD.		Q'TY N/A	CHKD: Camvard 05/08'08	DWG NO.: 343-0000-1131
			DR: THOMAS ZHAO 05/08'08	SCALE SHEET REV. N/A 2/2 C